



Technical Data

For detailed data and product description refer to the data sheets at www.pepperl-fuchs.com

General Data

Operating voltage	10 ... 30 V DC
No-load supply current	≤ 20 mA
Reverse polarity protection	✓
Operating current	0 ... 200 mA
Short-circuit protection	pulsing
Ambient temperature	-25 ... 70 °C (-13 ... 158 °F)
Housing material	PBT
Protection degree	IP67
Connection type	cable PVC , 2 m



Properties

- Ø21 mm and Ø43 mm inside diameter versions
- 6 mm / 9 mm minimum target diameter
- Mild steel targets
- Very fast response
- DC, 3-wire switching output

Model Number

			RJ21-E	RJ43-E	RJ21-E2	RJ43-E2
Inside diameter	21 mm		●		●	
	43 mm			●		●
Switching element function	NPN	NO	●	●		
	PNP	NO			●	●
Measuring cylinder	Diameter	6 mm	●		●	
		9 mm		●		●
	Length	12 mm	●		●	
	18 mm		●		●	
Switching frequency	0 ... 1000 Hz		●		●	
	0 ... 500 Hz			●		●

Approvals and Certificates

		RJ21-E	RJ43-E	RJ21-E2	RJ43-E2
UL approval	cULus Listed, General Purpose	●	●	●	●
CSA approval	cCSAus Listed, General Purpose	●	●	●	●

Dimensions

	20			
Length L [mm]				
Width W [mm]	45	70	45	70
Height H [mm]	80	100	80	100
Inside diameter D [mm]	21	43	21	43
Connector area l _c [mm]			0	

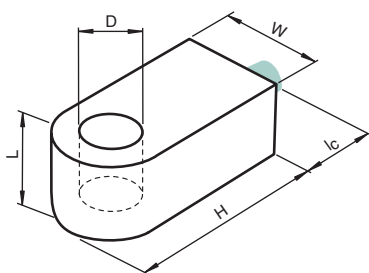

Electrical Connection



RJ21-E
RJ43-E

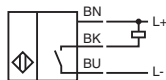

RJ21-E2
RJ43-E2

